

# TECHNICAL DATA

SINGLE DIRECTION VIBRATORY PLATES

BVP 10/30, BVP 12/50 A



## Handling

103.6 lb lightweight (BVP10/30)  
158.7 lb lightweight (BVP12/50A)



## Performance

Fast running and simple handling



## Costs

Maintenance free exciter (BVP10/30)

**Shipping dimensions in cub.yd**

<b>BVP 10/30</b>	0.146
<b>BVP 12/50 A</b>	0.328

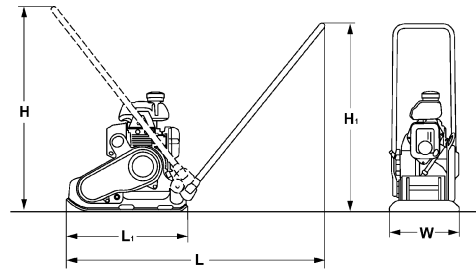

**Standard Equipment**

- Vibration insulated steering bow (BVP10/30)
- Detachable steering handle
- Highly wear resistant base plate (BVP10/30)
- Highly wear resistant cast iron base plate (BVP12/50A)
- Automatic shutdown at low oil level
- Recoil starter
- Single point lifting device
- Fully protected V-belt
- Carrying handles
- 3-2-1 Warranty
- Sprinkler system (BVP12/50A)

**Dimensions in in**

	H	H1	L	L1	W
<b>BVP 10/30</b>	19.3	33.1	41.7	20.0	11.8
<b>BVP 12/50 A</b>	26.0	35.0	38.2	20.9	19.7

**Technical Data**

**Weights**

Operating weight CECE .....	lb	104	159
Basic weight .....	lb	101	148

**Dimensions**

Working width .....	in	11.8	19.7
---------------------	----	------	------

**Driving Characteristics**

Working speed, max. ....	ft/min	82.0	82.0
Max. gradeability (dep. on soil con.) .....	%	30	30

**Drive**

Engine manufacturer .....		Honda	Honda
Type .....		GXR 120	GX 120
Emission stage .....		StageV/CARB P.3	StageV/CARB P.3
Cooling .....		air	air
Number of cylinders .....		1	1
Performance SAE J 1349 .....	hp	2.8	3.5
Speed .....	min-1	3.600	3.600
Drive system .....		mech.	mech.
Fuel .....		Gasoline	Gasoline
Fuel consump. aver. during operation .....	gal/h	0.2	0.2

**Exciter system**

Frequency .....	vpm	100	94
Centrifugal force .....	lb	10.00	12.00
Amplitude .....	in	0.053	0.043

**Capacities**

Fuel .....	gal	0.2	0.5
Water .....	gal	-	1.8

Technical modifications reserved. Machines may be shown with options.

**Optional Equipment**

- Special painting
- Plastic mat (BVP10/30)
- Service Kit
- TOUGH WARRANTY (BVP12/50A)
- Comfort guide handle (BVP10/30)



PRUS 834 19 010

150519 Sa03

**BOMAG Americas, Inc.**  
 125 Blue Granite Parkway  
 Ridgeway, SC 29130  
 USA  
 Tel. +1 803 3370700  
 Fax +1 803 3370800  
 www.bomag.com/us

